

Fuseholders for Midget Fuses, Panel Mount Type, 571 Series

Two panel mount fuseholder designs are available for supplementary or Class CC branch circuit protection. Class CC fuses have a rejection feature on one end cap which mates with the rejection feature of Class CC fuse blocks and fuseholders to prevent the installation of fuses with lower voltage ratings or interrupting ratings.

Specifications

- Electrical:**
 Rated at 30 amperes for any voltage up to 600 volts.
- Dielectric Strength:**
 4000 volts minimum.
- Mounting:**
 Flange mounting either in front of or behind panel. Watertight version must be front panel mounted. Maximum panel thickness is 0.75" (19.1mm).
- Molded Parts:**
 Black thermoplastic (UL94 V-0).
- Knob:**
 Screw type, with engraved markings: unfilled characters (571 007, 571 008, 571 007P, 571 008P), light blue characters (571 027, 571 028, 571 027P, 571 028P).
- Terminals:**
 Brass. Tin-plated. Combination solder and 1/4" (6.35mm) Quick-Connect. Side terminal has 0.125" (3.2mm) diameter hole. Bottom terminal has 0.156" x 0.124" (4.0 x 3.2)mm elongated hole.
- Ambient Temperature:**
 -40°C to +85°C.
- Hardware:**
 571 007, 571 008, 571 027, 571 028, 571 OCC, and 571 RCC, none; 571 007P, 571 008P, 571 027P, 571 028P, 571 OCCP, and 571 RCCP, two O-rings for watertight seal per MIL-PRF-19207.
- APPROVALS:**
 Recognized under the Components Program of Underwriters Laboratories and Certified by CSA.



Ordering Information

Catalog Number		Bottom Terminal	Fuse Length Range*	For Use With
Standard	Watertight			
571 027	571 027P	Straight	1 ⁵ / ₁₆ " – 1 ³ / ₈ " (33.3 – 34.9)mm	Midget Fuses
571 028	571 028P	Rt. Angle		
571 007	571 007P	Straight	1 ¹³ / ₃₂ " – 1 ¹ / ₂ " (35.7 – 38.1)mm	Midget Fuses
571 008	571 008P	Rt. Angle		
571 OCC	571 OCCP	Straight	1 ¹ / ₂ "	Class CC
571 RCC	571 RCCP	Rt. Angle	38.1 mm	Fuses

*Fuse diameter is 1³/₃₂" (10.3 mm)

Note: Contact the factory for versions with pre-assembled wire leads.

O-Rings: 901-184 (body)
901-260 (knob)

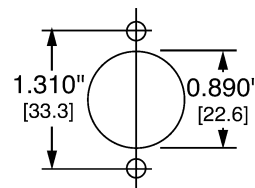
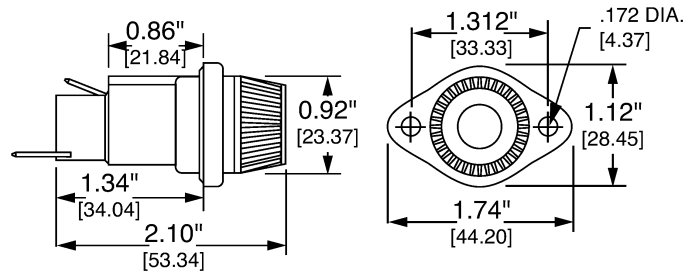

Mounting Hole