

Europe - Mains Appliance Line Socket 155°C / 16 Amp.

SPECIFICATIONS

- Mains Appliance Line Socket 155°C / 16A, Grounding Contact, Rewireable, Strain Relief
- Ratings: 16A / 250V AC
- Standard: DIN EN 60320-1 / C21
- Terminals: Screw-Type
- Contacts: CuZn 37
- Parts & Housing: Polyamide 6
- Approvals: ENEC, VDE



Catalog No.	Ratings	Color	Description (Wire Types)	VPE/Pack	EDP-No.
764BK	155°C, 16A-250V AC	Black	H05RR-F 3G1.0mm ² and 3G1.5mm ² Wire Stripping: Neutral, Line and Ground 20.0mm	100 ea	122560

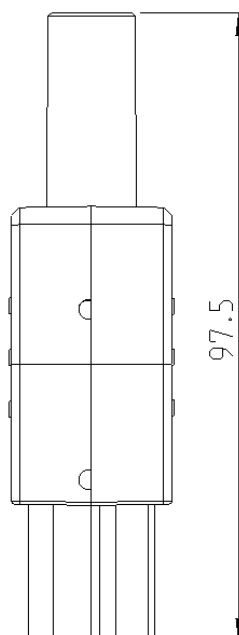
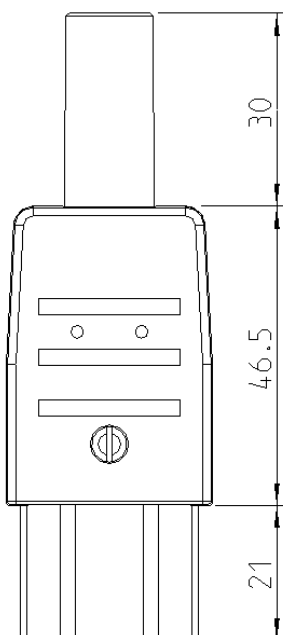
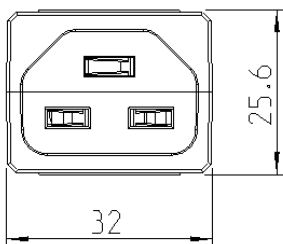

Europe - Mains Appliance Inlet 155°C / 16 Amp.

SPECIFICATIONS

- **Mains Appliance Inlet 155°C / 16A with Grounding Contact**
- **Ratings:** 16A / 250V AC
- **Standard:** DIN EN 60320-1 / C22
- **Terminals:** Screw-Type
- **Contacts:** CuZn 39
- **Parts & Housing:** Compression-Moulding Compound Type 31 or 131.5



Catalog No.	Ratings	Color	Description	VPE/Pack	EDP-No.
784BK	155°C, 16A-250V AC	Black	Screw-Type Terminals (Standard Version)	100 ea	122551
784GY	155°C, 16A-250V AC	Gray	Screw-Type Terminals	100 ea	122554
784WH	155°C, 16A-250V AC	White	Screw-Type Terminals	100 ea	122555

